

Installation Guide

AB-QM DN 40-100

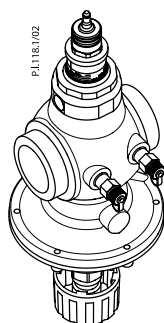

DN 40/50

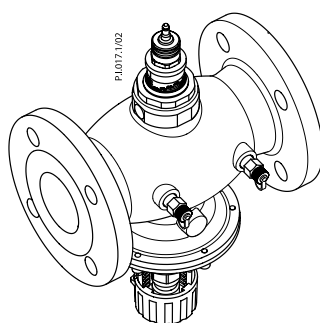

DN 50

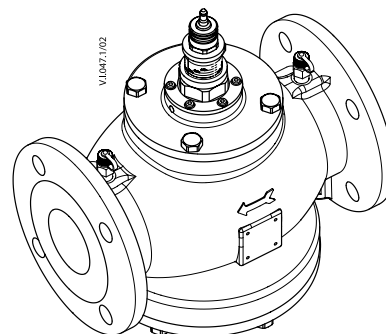

DN 65-100

Installation / Montering / Einbau / Installation / Installatie / Installation / Asennus / Montaż / Uzstādīšana / Beépítés / Montaj / Монтаж / Instalace / 安装 / Vgradnja / Instalación / Montavimas

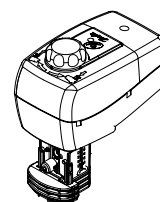
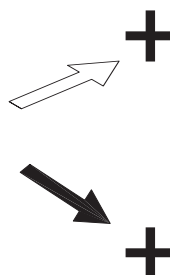
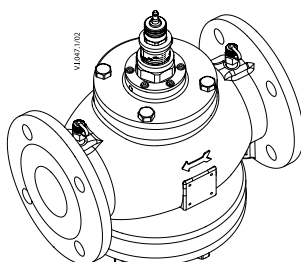
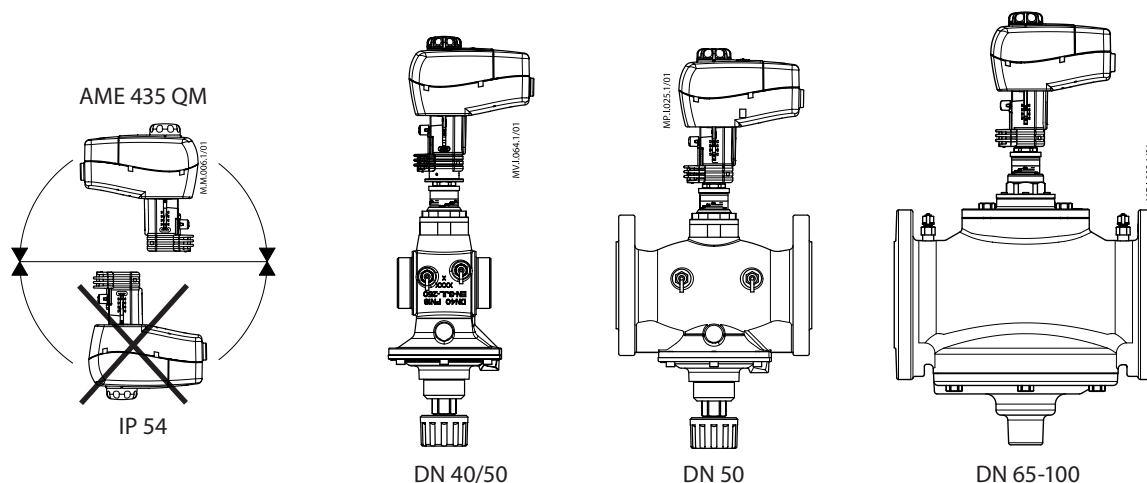

AME 435 QM



Code No.: 003Z0695

Installation Guide AB-QM DN 40-100

Shut off / Afspærring / Absperrung / Fermeture / Afsluiten / Avstängning / Sulkuventtiili / Funkcja odcięcia / Aizvēršana / Elzárás / KAPAMA / Отключение / Uzavření / 关闭 / Zapiranje pretoka / Corte / Uždarymas

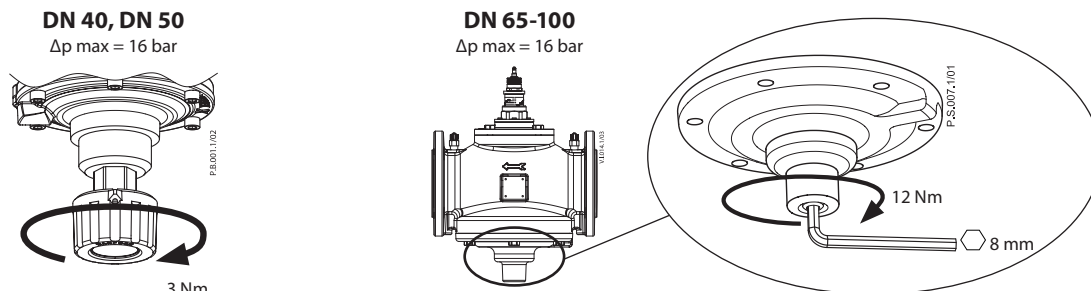

Setting / Indstilling / Einstellung / Réglage / Instelling / Inställning / Asettelu / Wykonywanie nastawy / Iestādījumi / Beállítás / Ayarlama / Настройка / Nastavení / 设定 / Nastavitev / Ajuste / Nustatymas

Note: best before applying pressure

DN 40/50

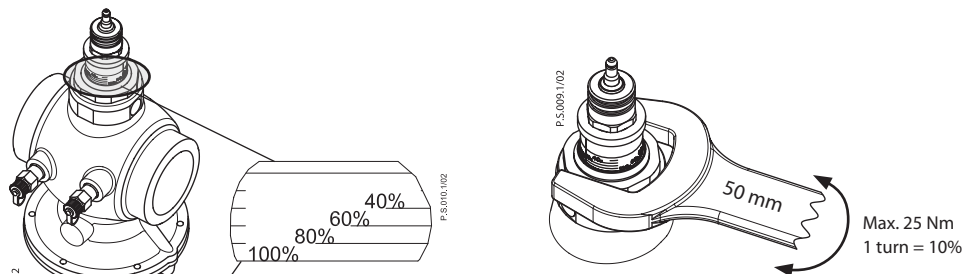

DN 65-100

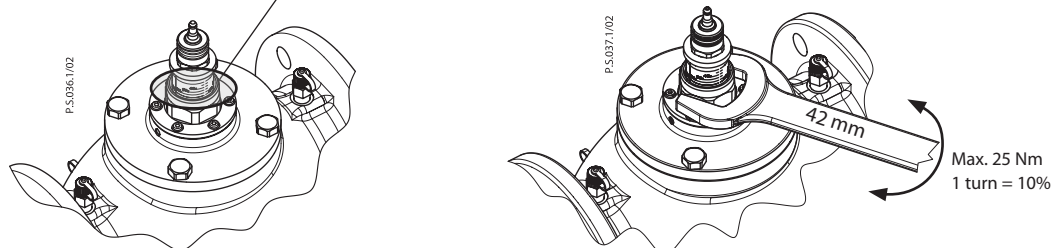

Resetting

DN 40-100

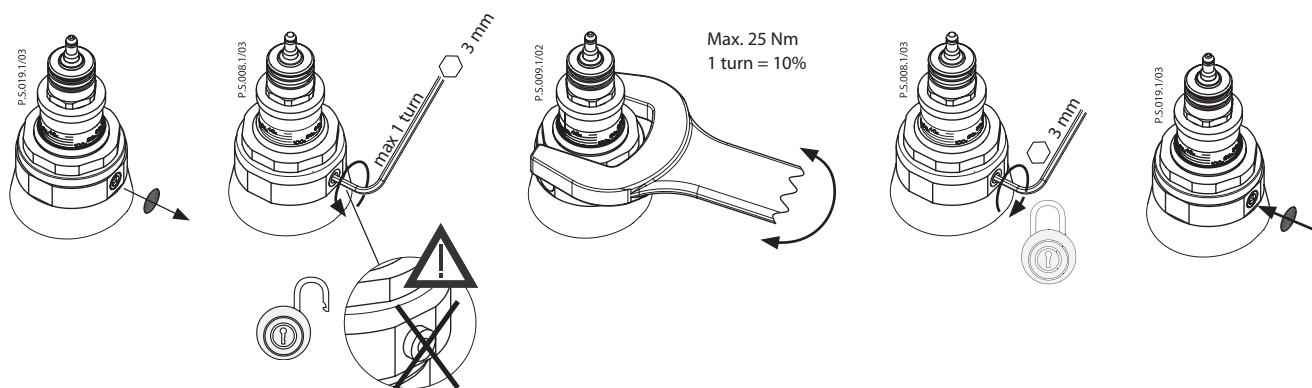

Installation Guide AB-QM DN 40-100

Locking / Låsning / Blockierung / Verrouillage / Vergrendelen / Låsning / Lukitseminen / Blokowanie nastawy / Noslēģšana / Korlátozás / Kilitle / Блокировка / Uzamykání / 锁定 / Blokiranje / Bloqueo / Blokavimas

DN 40/50

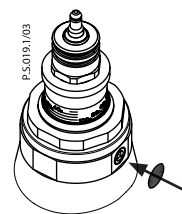
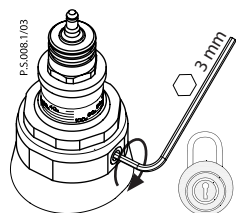

DN 65-100

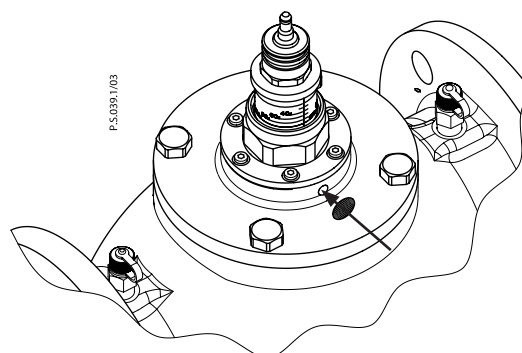
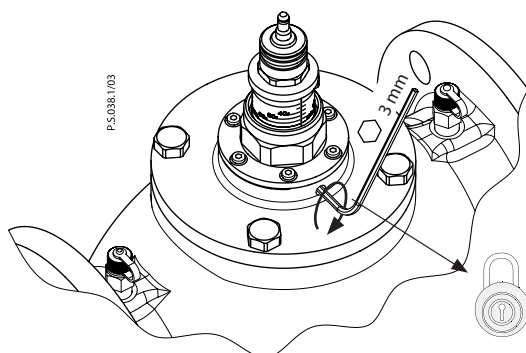

Measuring / Måling / Messung / Measure / Meten / Mätning / Mittaaminen / Wykonywanie pomiarów / Mērišana / Mérés / Ölçüm / Измерение / Měření / 測量 / Merjenje / Medida / Matavimas

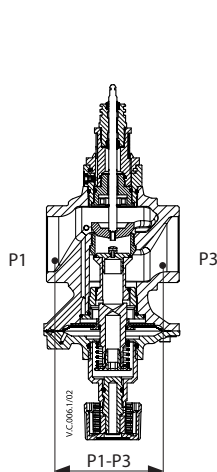

DN 40/50

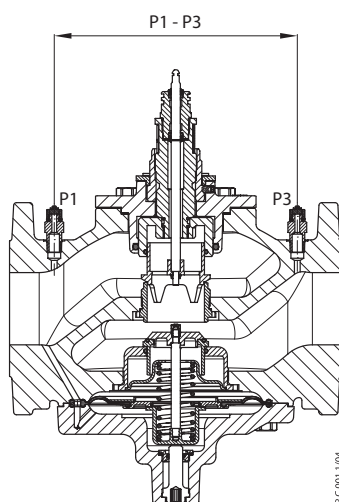

DN 65-100

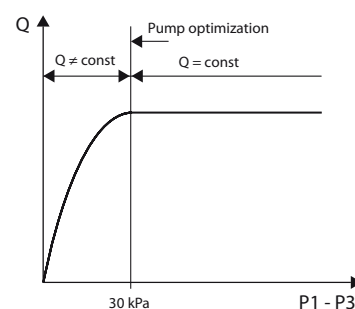

Installation Guide AB-QM DN 40-100



-10...120 °C



PN 16



$\Delta p_{\text{max.}} = 400 \text{ kPa (4 bar)}$

DN 40	L/h	L/s	GPM
20%	1500	0,416	6,6
25%	1875	0,520	8,3
30%	2250	0,625	9,9
35%	2625	0,729	11,6
40%	3000	0,833	13,2
45%	3375	0,937	14,9
50%	3750	1,041	16,5
55%	4125	1,145	18,2
60%	4500	1,250	19,8
65%	4875	1,354	21,5
70%	5250	1,458	23,1
75%	5625	1,562	24,8
80%	6000	1,666	26,4
85%	6375	1,770	28,1
90%	6750	1,875	29,7
95%	7125	1,979	31,4
100%	7500	2,083	33,0

Note: 1 turn = 10%

DN 50	L/h	L/s	GPM
40%	5000	1,386	22,0
45%	5625	1,562	24,8
50%	6250	1,736	27,5
55%	6875	1,909	30,3
60%	7500	2,083	33,0
65%	8125	2,256	35,8
70%	8750	2,430	38,50
75%	9375	2,604	41,3
80%	10000	2,777	44,0
85%	10625	2,951	46,8
90%	11250	3,125	49,5
95%	11875	3,298	52,3
100%	12500	3,472	55,0

Note: 1 turn = 10%

DN 65	L/h	L/s	GPM
40%	8000	2,22	35,2
45%	9000	2,50	39,6
50%	10000	2,78	44,0
55%	11000	3,06	48,4
60%	12000	3,33	52,8
65%	13000	3,61	57,2
70%	14000	3,89	61,6
75%	15000	4,17	66,0
80%	16000	4,44	70,4
85%	17000	4,72	74,9
90%	18000	5,00	79,3
95%	19000	5,28	83,7
100%	20000	5,56	88,1

Note: 1 turn = 10%

DN 80	L/h	L/s	GPM
40%	11200	3,11	49,3
45%	12600	3,50	55,5
50%	14000	3,89	61,6
55%	15400	4,23	67,8
60%	16800	4,67	74,0
65%	18200	5,10	80,1
70%	19600	5,44	86,3
75%	21000	5,83	92,5
80%	22400	6,22	98,6
85%	23800	6,61	104,8
90%	25200	7,00	111,0
95%	26600	7,39	117,1
100%	28000	7,78	123,3

Note: 1 turn = 10%

DN 100	L/h	L/s	GPM
40%	15200	4,22	66,9
45%	17100	4,75	75,3
50%	19000	5,28	83,7
55%	20900	5,81	92,0
60%	22800	6,33	100,4
65%	24700	6,86	108,8
70%	26600	7,39	117,1
75%	28500	7,92	125,5
80%	30400	8,44	133,8
85%	32300	8,97	142,2
90%	34200	9,50	150,6
95%	36100	10,03	158,9
100%	38000	10,56	167,3

Note: 1 turn = 10%